



SIDE ELEVATION (SOUTH WEST) 1:100



SIDE ELEVATION (NORTH EAST) 1:100



FRONT ELEVATION (SOUTH EAST) 1:100

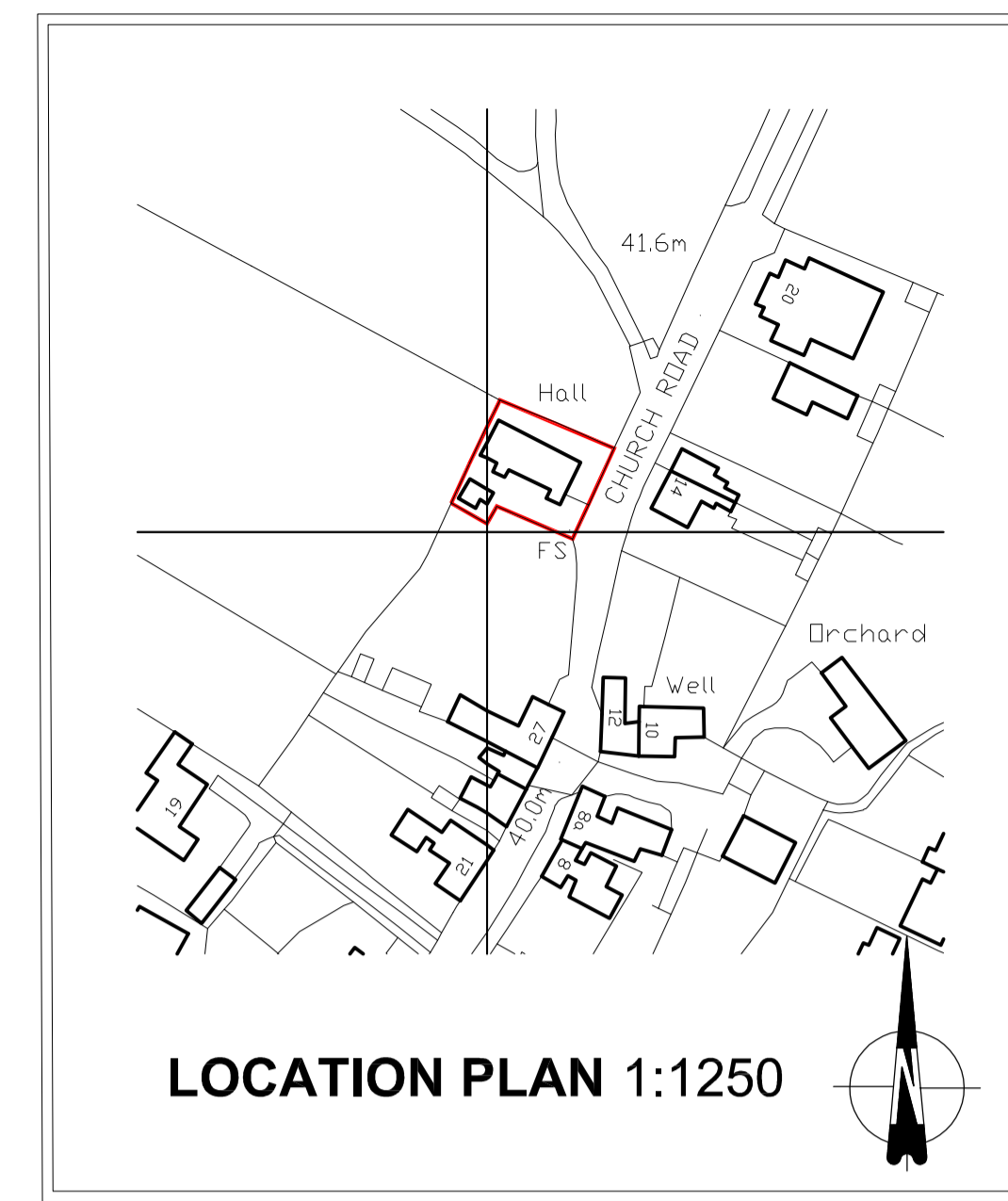

Crown Copyright and database rights 2019. OS 100031961
National Map Centre. Purchased 20/06/2019 1 year licence.

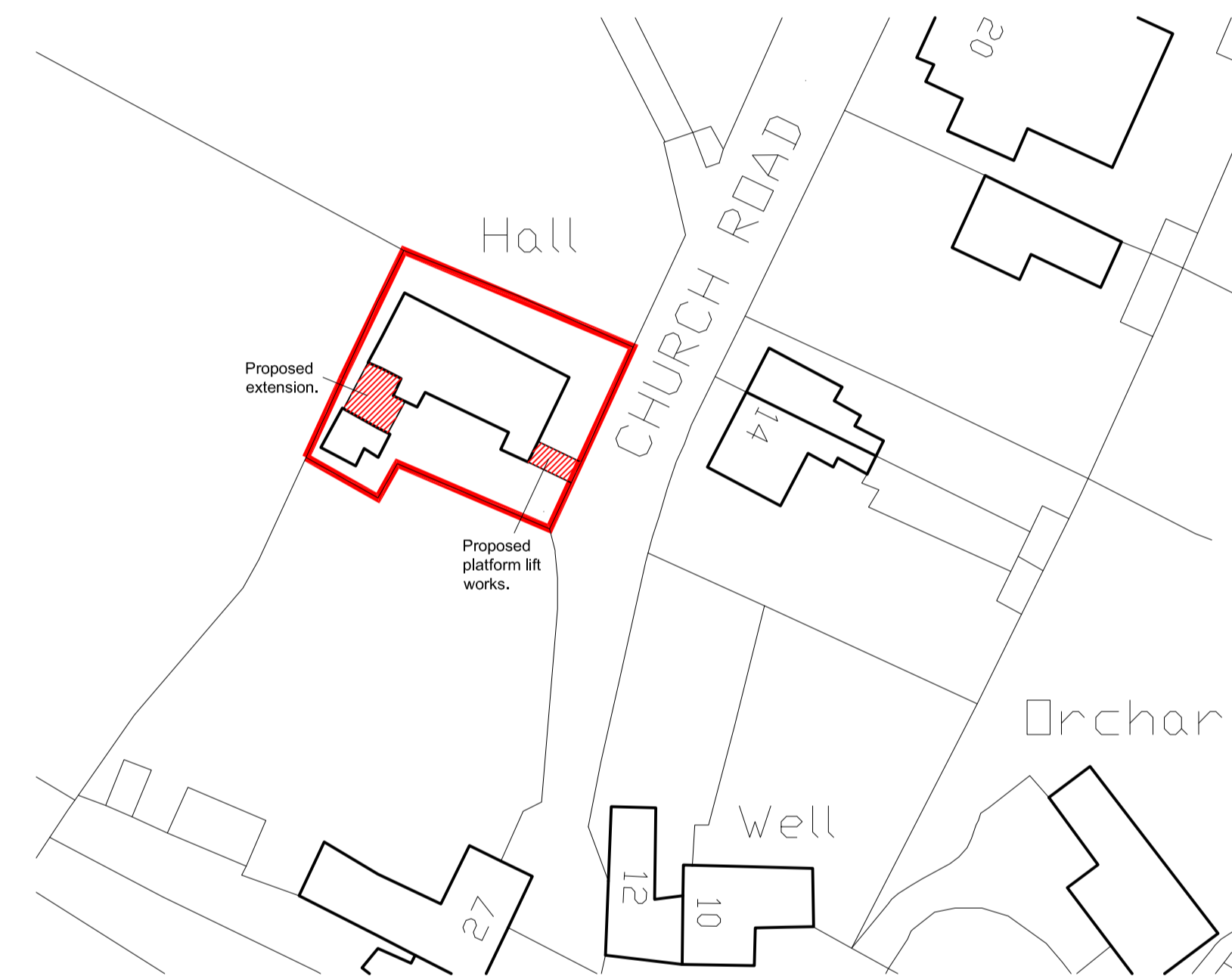

BLOCK PLAN 1:500



REAR ELEVATION (NORTH WEST) NTS

NOTES
Survey completed with limited access to certain areas. Where access was limited, estimations had to be made. All dimensions to be checked on site. It is recommended that a Topographical Survey is carried out so that an accurate plans showing all levels and heights can be achieved. Drawings and documents to be read in conjunction with one another. These drawings are prepared for the purpose of a PLANNING APPLICATION only.

B. Changes made as per client requests.
A. Platform lift added as client request.

Lifestyle Design Architects Ltd
119 Dowthorpe Hill
Earls Barton
Northampton
NN6 0PX
Tel: 01604 812800



arb Architects
Registration
Board

PROJECT

**PROPOSED DEVELOPMENT,
ST MARY'S CHURCH ROOM,
CHURCH ROAD, STEVINGTON,
BEDS MK43 7QB**

TITLE

**EXISTING PLANS AND
ELEVATIONS**

SCALE
1:100 @A1

DRAWN BY
SAR

DWG No
L/662/03B

Company Number 6424339